

SECTION 5 PARTS LIST

SAFETY PRECAUTION

Parts identified by the  symbol are critical for safety. Replace only with specified part numbers.

5.1 MECHANISM ASSEMBLY <M4>

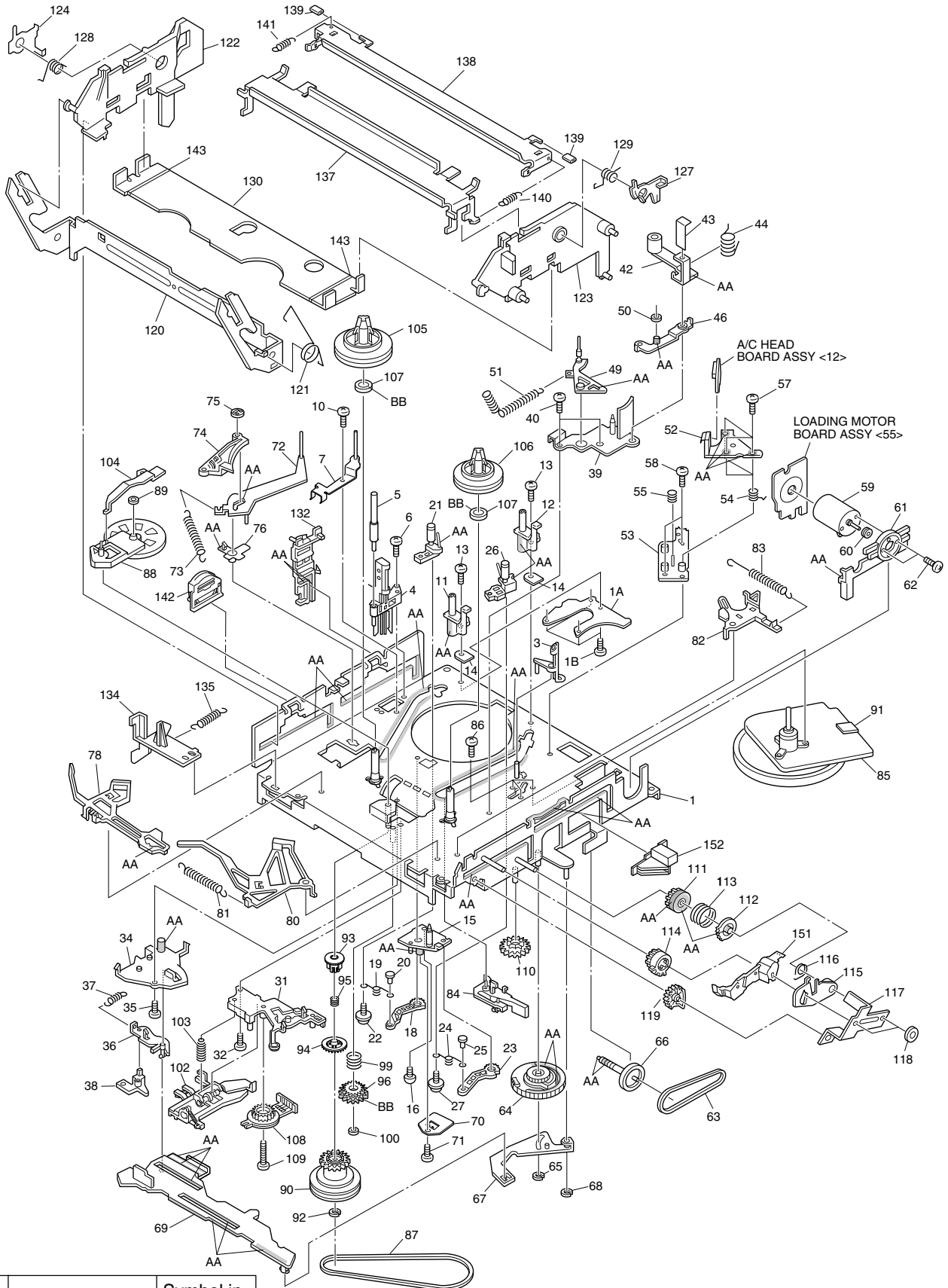

Classification	Part No.	Symbol in drawing
Grease	KYODO-SH-P	AA
Oil	COSMO-HV56	BB

NOTE: The section marked in **AA** and **BB** indicate lubrication and greasing areas.

#	△ REF No.	PART No.	PART NAME, DESCRIPTION

MECHANISM ASSEMBLY <M4>			
1		LP20884-002F	MAIN DECK ASSY
1A		LP40275-002B	PLATE(SUPPLY)
1B		QYTDST2606Z	SCREW,X4
3		LP30492-002B	GIDE POOL GUARD
4		NAH0001-001	FULL ERASE HEAD
5		LP40098-001B	GUIDE POLE(SUPPLY)
6		QYTDST2608Z	SCREW
7		LP40637-002A	TENSION STUD BASE ASSY
10		QYTDST2606Z	SCREW
11		LP30409-002C	UV CATCHER 2
12		LP30409-002C	UV CATCHER 2
13		QYTPST2606Z	SCREW,X2
14		PQ40919-10	SPACER,X2,UV CATCHER 2
15		LP30223-003C	LOADING ARM GEAR SHAFT
16		QYTDST2606Z	SCREW
18		LP30224-001B	LOADING ARM GEAR(SUPPLY)
19		LP40099-001A	TORSION ARM
20		LP40100-001A	PIN
21		LP40101-007A	POLE BASE ASSY(SUPPLY)
22		QYSPSTG2606Z	SCREW
23		LP40103-002B	LOADING ARM GEAR(TAKE UP)
24		LP40099-001E	TORSION ARM
25		LP40100-001A	PIN
26		LP40104-008A	POLE BASE ASSY(TAKE UP)
27		QYSPSTG2606Z	SCREW
31		LP20233-004B	ROTARY ENCODER GUIDE
32		QYTPST2606Z	SCREW
34		LP30226-004E	CONTROL PLATE GUIDE
35		QYTPST2605Z	SCREW
36		LP30249-003B	TAKE UP LEVER
37		LP30003-006A	TENSION SPRING
38		LP40119-002A	TAKE UP HEAD
39		LP20234-004B	LID GUIDE
40		QYTDST2606Z	SCREW,X2
42		LP40105-003A	PINCH ROLLER ARM ASSY
43		LP40753-001A	PINCH ROLLER SHEET3
44		LP40148-002A	TORSION SPRING
46		LP40149-001C	PRESS LEVER ASSY
49		LP40106-002E	GUIDE ARM ASSY
50		LP30017-008A	SPACER
51		LP40134-002A	TENSION SPRING
52		QAH0010-004	AC HEAD
53		LP30228-001C	HEAD BASE
54		LP30004-013A	COMPRESSION SPRING,X3
55		LP40236-001A	COMPRESSION SPRING
57		LP40213-002B	SPECIAL SCREW,X3
58		QYTDST2608Z	SCREW,X2
59		QAR0023-001	LOADING MOTOR
60		PQ43546-1-2	MOTOR PULLEY
61		LP30230-001B	MOTOR GUIDE
62		QYTPSP3003Z	SCREW,X2
63		LP30005-003A	BELT,LOADING MOTOR
64		LP20791-002D	CONTROL CAM
65		PQM30017-24	SLIT WASHER
66		LP40120-001A	WORM GEAR
67		LP40107-002A	LINK LEVER ASSY
68		PQM30017-24	SLIT WASHER
69		LP10284-002E	CONTROL PLATE
70		LP40379-001B	CONTROL BRACKET(1)
71		QYTDSF2608M	SCREW

#	△ REF No.	PART No.	PART NAME, DESCRIPTION
72		LP40108-002A	TENSION ARM ASSY
73		LP30003-010A	TENSION SPRING
74		LP40109-003D	TENSION BRAKE ASSY
75		PQ46302-1-3	ADJUST PIN
76		LP30232-002A	TENSION ARM BEARING
78		LP40532-009B	MAIN BRAKE ASSY (SUPPLY)
80		LP40111-014C	MAIN BRAKE ASSY (TAKE UP)
81		LP30003-029A	TENSION SPRING
82		LP40112-001F	SUB BRAKE ASSY(TAKE UP)
83		LP40357-001B	TENSION SPRING
84		LP40461-001A	CAPSTAN BRAKE ASSY
85		QAR0132-001	CAPSTAN MOTOR
86		QYTDSF2606M	SCREW,X3
87		LP30005-008B	BELT,CAPSTAN MOTOR
88		LP40114-011B	IDLER ARM ASSY
89		LP30016-001A	SLIT WASHER
90		LP40593-003B	CLUTCH UNIT 3
91		LP30002-097A	SPACER,CAPSTAN MOTOR
92		PQM30017-47	SLIT WASHER
93		LP30696-002A	CLUTCH GEAR 4
94		LP30697-003A	COUPLING GEAR
95		LP40554-002A	COMPRESSION SPRING
96		LP40442-001A	DIRECT GEAR
99		LP40483-002A	COMPRESSION SPRING
100		LP30016-001A	SLIT WASHER
102		LP40484-003B	CHANGE LEVER ASSY
103		LP40512-002B	COMPRESSION SPRING
104		LP30236-002C	IDLER LEVER
105		LP20237-003B	REEL DISK ASSY(SUPPLY)
106		LP20238-003B	REEL DISK ASSY(TAKE UP)
107		LP30017-015A	SPACER,X2
108		QSW0554-003	ROTARY ENCODER
109		LP40746-001A	SPECIAL SCREW
110		LP30237-002B	CASSETTE GEAR
111		LP30239-002G	LIMIT GEAR(1)
112		LP30240-002G	LIMIT GEAR(2)
113		LP40136-001E	TORSION SPRING
114		LP30242-002A	RELAY GEAR
115		LP30339-002E	OPENER GUIDE
116		LP40545-001A	TORSION SPRING
117		LP40214-001B	C.H.BRACKET
118		PQM30017-47	SLIT WASHER,X2
119		LP30243-002A	DRIVE GEAR
120		LP20240-001G	DRIVE ARM
121		LP40137-001A	TORSION SPRING
122		LP10081-002L	SIDE HOLDER(L)
123		LP10082-002M	SIDE HOLDER(R)
124		LP30255-006A	LOCK LEVER(L)
127		LP30256-001H	LOCK LEVER(R)
128		LP40168-001A	TORSION SPRING(L)
129		LP40218-001B	TORSION SPRING(R)
130		LP30257-001G	CASSETTE HOLDER
132		LP30244-002G	GUIDE RAIL
134		LP30245-002F	REC SAFETY LEVER
135		LP30003-004A	TENSION SPRING
137		LP20578-001C	TOP GUIDE
138		LP30500-001C	HOLD PLATE
139		LP40450-003A	PAD,X2
140		LP30003-025B	TENSION SPRING
141		LP30003-024A	TENSION SPRING
142		LP40481-003A	ROLLER CAM ASSY
143		LP30019-014A	PAD,X2
151		LP20324-003B	DOOR OPENER
152		LP30493-001B	START SENSOR CAP

5.2 ELECTRICAL PARTS LIST

#	△	REF No.	PART No.	PART NAME, DESCRIPTION	#	△	REF No.	PART No.	PART NAME, DESCRIPTION

MAIN BOARD ASSEMBLY <03>									
			PW1	LPA10106-51C1					MAIN BOARD ASSY
			IC1	JCP8022-NSD-2				IC	
			IC2501	LC85405JE				IC	
			IC3001	HD6432194AA06F				IC (MCU)	
			IC3002	S-80727AN-DQ-X				IC	
				or S-80827ANUP-W				IC	
				or R3111H271A				IC	
			IC3003	AT24C08-10PC				IC	
				or BR24C08				IC	
				or M24C08-BN6				IC	
				or S-24C08ADP				IC	
				or 24LC08B/P				IC	
			IC3004	BA6956AN				IC	
			IC3501	BA6956AN				IC	
			IC3601	BU2090FS				IC	
			IC3651	BU2090FS				IC	
			IC5101	STR-G6532				IC	
			IC5301	LA5644				IC	
			Q5	2SA1576A/QR/-X				TRANSISTOR	
				or 2PA1576/R/-X				TRANSISTOR	
			Q7	2SC4081/QRS/-X				TRANSISTOR	
				or 2PC4081/R/-X				TRANSISTOR	
			Q8	2SC4081/QRS/-X				TRANSISTOR	
				or 2PC4081/R/-X				TRANSISTOR	
			Q9	2SA1576A/QR/-X				TRANSISTOR	
				or 2PA1576/R/-X				TRANSISTOR	
			Q12	2SA1576A/QR/-X				TRANSISTOR	
				or 2PA1576/R/-X				TRANSISTOR	
			Q17	DTC144WU				DIGI TRANSISTOR	
				or PDTC144WU				DIGI TRANSISTOR	
				or RN1309				DIGI TRANSISTOR	
				or UN521E				DIGI TRANSISTOR	
			Q21	2SA1576A/QR/-X				TRANSISTOR	
				or 2PA1576/R/-X				TRANSISTOR	
			Q24	2SA1576A/QR/-X				TRANSISTOR	
				or 2PA1576/R/-X				TRANSISTOR	
			Q38	2SC4081/QRS/-X				TRANSISTOR	
				or 2PC4081/R/-X				TRANSISTOR	
			Q401	2SA1576A/QR/-X				TRANSISTOR	
			Q402	2SA1576A/QR/-X				TRANSISTOR	
			Q403	DTC144WU				DIGI TRANSISTOR	
				or PDTC144WU				DIGI TRANSISTOR	
				or RN1309				DIGI TRANSISTOR	
				or UN521E				DIGI TRANSISTOR	
			Q404	DTC144WU				DIGI TRANSISTOR	
				or PDTC144WU				DIGI TRANSISTOR	
				or RN1309				DIGI TRANSISTOR	
				or UN521E				DIGI TRANSISTOR	
			Q405	2SA1576A/QR/-X				TRANSISTOR	
			Q2001	2SC4081/QRS/-X				TRANSISTOR	
				or 2SD1819A/QRS/-X				TRANSISTOR	
				or 2PC4081/R/-X				TRANSISTOR	
			Q2002	2SC4081/QRS/-X				TRANSISTOR	
				or 2PC4081/R/-X				TRANSISTOR	
				or 2SD1819A/QRS/-X				TRANSISTOR	
			Q2003	DTA144WU				DIGI TRANSISTOR	
				or PDTA144WU				DIGI TRANSISTOR	
				or RN2309				TRANSISTOR	
				or UN511E				DIGI TRANSISTOR	
			Q2004	DTC144WU				DIGI TRANSISTOR	
				or PDTC144WU				DIGI TRANSISTOR	
				or RN1309				DIGI TRANSISTOR	
				or UN521E				DIGI TRANSISTOR	
			Q2052	2SA1576A/QR/-X				TRANSISTOR	
				or 2PA1576/R/-X				TRANSISTOR	
				or 2SB1218A/QR/-X				TRANSISTOR	
			Q2053	DTC144WU				DIGI TRANSISTOR	
				or PDTC144WU				DIGI TRANSISTOR	
				or RN1309				DIGI TRANSISTOR	
				or UN521E				DIGI TRANSISTOR	
			Q2054	2SA1576A/QR/-X				TRANSISTOR	
				or 2SB1218A/QR/-X				TRANSISTOR	
				or 2PA1576/R/-X				TRANSISTOR	
			Q2061	2SC4081/QRS/-X				TRANSISTOR	
				or 2PC4081/R/-X				TRANSISTOR	
				or 2SD1819A/QRS/-X				TRANSISTOR	
			Q2062	2SA1576A/QR/-X				TRANSISTOR	
				or 2SB1218A/QR/-X				TRANSISTOR	
				or 2PA1576/R/-X				TRANSISTOR	
			Q2102	DTC114EU				DIGI TRANSISTOR	
				or PDTC114EU				DIGI TRANSISTOR	
				or RN1302				DIGI TRANSISTOR	
				or UN5211				DIGI TRANSISTOR	
			Q2103	2SC4081/QRS/-X				TRANSISTOR	
				or 2PC4081/R/-X				TRANSISTOR	
				or 2SD1819A/QRS/-X				TRANSISTOR	
			Q2104	DTA144WU				DIGI TRANSISTOR	
				or PDTA144WU				DIGI TRANSISTOR	
				or RN2309				TRANSISTOR	
				or UN511E				DIGI TRANSISTOR	
			Q2105	DTC144WU				DIGI TRANSISTOR	
				or PDTC144WU				DIGI TRANSISTOR	
				or RN1309				DIGI TRANSISTOR	
				or UN521E				DIGI TRANSISTOR	
			Q2108	2SC4081/QRS/-X				TRANSISTOR	
				or 2SD1819A/QRS/-X				TRANSISTOR	
				or 2PC4081/R/-X				TRANSISTOR	
			Q2251	DTA144WU				DIGI TRANSISTOR	
				or PDTA144WU				DIGI TRANSISTOR	
				or RN2309				TRANSISTOR	
				or UN511E				DIGI TRANSISTOR	
			Q2501	2SC4081/QRS/-X				TRANSISTOR	
				or 2PC4081/R/-X				TRANSISTOR	
				or 2SD1819A/QRS/-X				TRANSISTOR	
			Q2502	DTC144WU				DIGI TRANSISTOR	
				or PDTC144WU				DIGI TRANSISTOR	
				or RN1309				DIGI TRANSISTOR	
				or UN521E				DIGI TRANSISTOR	
			Q3001	2SD1819A/QRS/-X				TRANSISTOR	
				or 2SC4081/QRS/-X				TRANSISTOR	
				or 2PC4081/R/-X				TRANSISTOR	
			Q3002	PTZ-NV16				PHOTO TRANSISTOR	
				or PTZ-NV16A				PHOTO TRANSISTOR	
			Q3003	PTZ-NV16				PHOTO TRANSISTOR	
				or PTZ-NV16A				PHOTO TRANSISTOR	
			Q3004	2SD1819A/QRS/-X				TRANSISTOR	
				or 2PC4081/R/-X				TRANSISTOR	
				or 2SC4081/QRS/-X				TRANSISTOR	

#	△ REF No.	PART No.	PART NAME, DESCRIPTION	#	△ REF No.	PART No.	PART NAME, DESCRIPTION	
Q3005		2SD1819A/QRS/-X	TRANSISTOR			or 10ELS4	FR DIODE	
		or 2SC4081/QRS/-X	TRANSISTOR	D5103		AU01Z	FR DIODE	
		or 2PC4081/R/-X	TRANSISTOR			or ERA18-02-T2	FR DIODE	
Q3009		UN521E	DIGI TRANSISTOR			or 1SR153-400-T2	FR DIODE	
		or PDTC144WU	DIGI TRANSISTOR			or 10ELS2	FR DIODE	
		or RN1309	DIGI TRANSISTOR			or PG104RS	FR DIODE	
		or DTC144WU	DIGI TRANSISTOR	D5201		AK04	DIODE	
Q3501		2SD1819A/QRS/-X	TRANSISTOR			or 1S4	SB DIODE	
		or 2SC4081/QRS/-X	TRANSISTOR			or 11EQS04	SB DIODE	
		or 2PC4081/R/-X	TRANSISTOR	D5202		FML-12S	FR DIODE	
Q4001		UN5211	DIGI TRANSISTOR			or FCF06A20	FR DIODE	
		or RN1302	DIGI TRANSISTOR			or ER602FCT	FR DIODE	
		or PDTC114EU	DIGI TRANSISTOR			or YG901C2	FR DIODE	
		or DTC114EU	DIGI TRANSISTOR			or SF5LC20U	FR DIODE	
Q4003		UN5211	DIGI TRANSISTOR	D5206		FMB-24	BARRIER DIODE	
		or RN1302	DIGI TRANSISTOR			or SB640FCT	SB DIODE	
		or DTC114EU	DIGI TRANSISTOR			or SF5SC4	SB DIODE	
		or PDTC114EU	DIGI TRANSISTOR			or YG801C04	SB DIODE	
Q5301		2SB1256	TRANSISTOR			or FSQ05A04B	SB DIODE	
Q5302		DTC114TU	DIGI TRANSISTOR	D5209		ERA18-02-T2	FR DIODE	
		or PDTC114TU	DIGI TRANSISTOR			or PG104RS	FR DIODE	
		or UN5215	DIGI TRANSISTOR			or 1SR153-400-T2	FR DIODE	
		or RN1311	TRANSISTOR			or 10ELS2	FR DIODE	
Q5320		2SB1256	TRANSISTOR	D5210		AU01Z	FR DIODE	
Q5321		DTC114TU	DIGI TRANSISTOR			or ERA18-02-T2	FR DIODE	
		or PDTC114TU	DIGI TRANSISTOR			or PG104RS	FR DIODE	
		or RN1311	TRANSISTOR			or 10ELS2	FR DIODE	
		or UN5215	DIGI TRANSISTOR			or 1SR153-400-T2	FR DIODE	
Q5322		DTA114EU	DIGI TRANSISTOR	D5211		AU01Z	FR DIODE	
		or PDTA114EU	DIGI TRANSISTOR			or PG104RS	FR DIODE	
		or RN2302	TRANSISTOR			or 1SR153-400-T2	FR DIODE	
		or UN5111	DIGI TRANSISTOR			or ERA18-02-T2	FR DIODE	
Q6501		DTC143TU	DIGI TRANSISTOR			or 10ELS2	FR DIODE	
Q6502		DTC143TU	DIGI TRANSISTOR	D5214		ERA18-02-T2	FR DIODE	
Q6551		2SC1740S/QRS/-T	TRANSISTOR			or PG104RS	FR DIODE	
		or 2SC3199/YG/-T	TRANSISTOR			or 10ELS2	FR DIODE	
Q7201		2SC1317/RS/-T	TRANSISTOR			or 1SR153-400-T2	FR DIODE	
D2001		1SS355	DIODE	D5301		MTZJ15A	ZENER DIODE	
D2121		MTZJ8.2C	ZENER DIODE			or RD15ES/B1/-T2	ZENER DIODE	
D2201		11ES2	DIODE	D5302		MTZJ6.8A	ZENER DIODE	
		or 1A3G	DIODE			or RD6.8ES/B1/-T2	ZENER DIODE	
D2501		1SS133	DIODE	D5303		MTZJ27C	ZENER DIODE	
D3001		LNB2301L01VI	LE DIODE			or RD27ES/B3/-T2	ZENER DIODE	
D3002		1SS133	DIODE	D5304		1SS133	DIODE	
D3003		RD39ES/B3/-T2	ZENER DIODE			or 1SS270A	DIODE	
		or MTZJ39C	ZENER DIODE	D5305		11ES2	DIODE	
D3004		11E2-T5	DIODE			or 1A3G	DIODE	
D3005		11E2-T5	DIODE			or ERA15-02-T2	DIODE	
D3007		1SS355	DIODE	D5314		QUY160-100Y	IM BUS WIRE	
D4001		1SS355	DIODE	D5315		11ES2	DIODE	
D4002		1SS355	DIODE			or 1A3G	DIODE	
D5001		S1WB/A/60-4102	BRIDGE DIODE			or ERA15-02-T2	DIODE	
		or S1WB/A/60-X	BRIDGE DIODE	D5316		QUY160-100Y	IM BUS WIRE	
		or S1WB(A)60F4072X	BRIDGE DIODE	D6002		HZ30-2L-T2	ZENER DIODE	
D5101		AU01	FR DIODE			or HZ30-2LTD	Z DIODE (M)	
		or ERA18-04-T2	FR DIODE	D6551		MTZJ10B	ZENER DIODE	
		or 10ELS4	FR DIODE	R1		NRVA02D-622X	CMF RESISTOR	6.2kΩ,1/10W
		or 1SR153-400-T2	FR DIODE	R2		NRVA02D-152X	CMF RESISTOR	1.5kΩ,1/10W
D5102		AU01	FR DIODE	R3		NRSA02J-182X	MG RESISTOR	1.8kΩ,1/10W
		or ERA18-04-T2	FR DIODE	R5		NRSA02J-0R0X	MG RESISTOR	0Ω,1/10W
		or 1SR153-400-T2	FR DIODE	R6		NRSA02J-103X	MG RESISTOR	10kΩ,1/10W

#	△	REF No.	PART No.	PART NAME, DESCRIPTION	#	△	REF No.	PART No.	PART NAME, DESCRIPTION
R7			NRSA02J-102X	MG RESISTOR	R2059			NRSA02J-473X	MG RESISTOR
R8			NRSA02J-0R0X	MG RESISTOR	R2060			NRSA02J-183X	MG RESISTOR
R9			NRSA02J-0R0X	MG RESISTOR	R2061			NRSA02J-273X	MG RESISTOR
R23			NRSA02J-102X	MG RESISTOR	R2062			NRSA02J-3R3X	MG RESISTOR
R25			NRSA02J-103X	MG RESISTOR	R2063			NRSA02J-151X	MG RESISTOR
R26			NRSA02J-822X	MG RESISTOR	R2064			NRSA02J-473X	MG RESISTOR
R27			NRSA02J-102X	MG RESISTOR	R2065			NRSA02J-183X	MG RESISTOR
R28			NRSA02J-102X	MG RESISTOR	R2102			NRSA02J-471X	MG RESISTOR
R29			NRSA02J-222X	MG RESISTOR	R2103			NRSA02J-472X	MG RESISTOR
R30			NRSA02J-0R0X	MG RESISTOR	R2104			NRSA02J-472X	MG RESISTOR
R31			NRSA02J-122X	MG RESISTOR	R2105			NRSA02J-562X	MG RESISTOR
R32			NRSA02J-102X	MG RESISTOR	R2106			NRSA02J-681X	MG RESISTOR
R34			NRSA02J-223X	MG RESISTOR	R2107			NRSA02J-102X	MG RESISTOR
R36			NRSA02J-182X	MG RESISTOR	R2109			NRSA02J-103X	MG RESISTOR
R39			NRSA02J-0R0X	MG RESISTOR	R2111			NRSA02J-222X	MG RESISTOR
R42			NRSA02J-681X	MG RESISTOR	R2121			QRE141J-151Y	RESISTOR
R44			NRSA02J-473X	MG RESISTOR	R2202			NRSA02J-222X	MG RESISTOR
R45			NRSA02J-153X	MG RESISTOR	R2203			NRSA02J-222X	MG RESISTOR
R46			NRSA02J-331X	MG RESISTOR	R2204			NRSA02J-102X	MG RESISTOR
R48			NRSA02J-102X	MG RESISTOR	R2205			NRSA02J-102X	MG RESISTOR
R51			NRSA02J-222X	MG RESISTOR	R2206			QRE141J-101Y	RESISTOR
R68			NRSA02J-222X	MG RESISTOR	R2208			QUY160-100Y	IM BUS WIRE
R70			NRSA02J-0R0X	MG RESISTOR	R2209			QUY160-100Y	IM BUS WIRE
R77			NRSA02J-223X	MG RESISTOR	R2210			NRSA02J-0R0X	MG RESISTOR
R88			NRSA02J-272X	MG RESISTOR	R2211			NRSA02J-0R0X	MG RESISTOR
R90			NRSA02J-471X	MG RESISTOR	R2213			QRE141J-393Y	RESISTOR
R92			NRSA02J-152X	MG RESISTOR	R2215			NRSA02J-153X	MG RESISTOR
R93			NRSA02J-102X	MG RESISTOR	R2217			NRSA02J-103X	MG RESISTOR
R94			NRSA02J-0R0X	MG RESISTOR	R2218			NRSA02J-393X	MG RESISTOR
R104			NRSA02J-682X	MG RESISTOR	R2219			QRE141J-393Y	RESISTOR
R113			NRSA02J-101X	MG RESISTOR	R2220			QRE141J-393Y	RESISTOR
R114			NRSA02J-0R0X	MG RESISTOR	R2223			NRSA02J-123X	MG RESISTOR
R401			NRSA02J-221X	MG RESISTOR	R2224			NRSA02J-123X	MG RESISTOR
R402			NRSA02J-102X	MG RESISTOR	R2225			NRSA02J-153X	MG RESISTOR
R403			NRSA02J-391X	MG RESISTOR	R2228			NRSA02J-0R0X	MG RESISTOR
R404			NRSA02J-473X	MG RESISTOR	R2251			NRSA02J-102X	MG RESISTOR
R405			NRSA02J-683X	MG RESISTOR	R2501			NRSA02J-0R0X	MG RESISTOR
R407			NRSA02J-472X	MG RESISTOR	R2502			NRSA02J-472X	MG RESISTOR
R408			NRSA02J-473X	MG RESISTOR	R2503			NRSA02J-563X	MG RESISTOR
R409			NRSA02J-103X	MG RESISTOR	R2504			NRSA02J-472X	MG RESISTOR
R2001			NRSA02J-101X	MG RESISTOR	R2505			NRSA02J-105X	MG RESISTOR
R2003			QRE141J-101Y	RESISTOR	R2506			NRSA02J-473X	MG RESISTOR
R2005			QRE141J-103Y	RESISTOR	R2507			NRSA02J-102X	MG RESISTOR
R2006			QRE141J-393Y	RESISTOR	R2508			NRSA02J-333X	MG RESISTOR
R2007			NRSA02J-393X	MG RESISTOR	R2509			NRSA02J-103X	MG RESISTOR
R2009			NRSA02J-123X	MG RESISTOR	R2510			NRSA02J-104X	MG RESISTOR
R2010			NRSA02J-123X	MG RESISTOR	R2511			NRSA02J-154X	MG RESISTOR
R2011			NRSA02J-103X	MG RESISTOR	R2512			NRSA02J-102X	MG RESISTOR
R2012			NRSA02J-153X	MG RESISTOR	R2513			NRSA02J-102X	MG RESISTOR
R2013			NRSA02J-682X	MG RESISTOR	R2514			NRSA02J-562X	MG RESISTOR
R2014			NRSA02J-224X	MG RESISTOR	R2519			NRSA02J-102X	MG RESISTOR
R2015			NRSA02J-271X	MG RESISTOR	R2520			NRSA02J-101X	MG RESISTOR
R2016			NRSA02J-473X	MG RESISTOR	R2522			NRSA02J-682X	MG RESISTOR
R2017			NRSA02J-183X	MG RESISTOR	R3011			QRE141J-0R0Y	RESISTOR
R2018			NRSA02J-472X	MG RESISTOR	R3012			NRSA02J-0R0X	MG RESISTOR
R2019			NRSA02J-472X	MG RESISTOR	R3013			NRSA02J-0R0X	MG RESISTOR
R2020			NRSA02J-102X	MG RESISTOR	R3016			QRE141J-0R0Y	RESISTOR
R2053			NRSA02J-472X	MG RESISTOR	R3017			QRE141J-0R0Y	RESISTOR
R2056			NRSA02J-101X	MG RESISTOR	R3018			QRE141J-682Y	RESISTOR
R2057			NRSA02J-473X	MG RESISTOR	R3019			QRE141J-0R0Y	RESISTOR
R2058			NRSA02J-183X	MG RESISTOR	R3022			NRSA02J-472X	MG RESISTOR

#	△ REF No.	PART No.	PART NAME, DESCRIPTION	#	△ REF No.	PART No.	PART NAME, DESCRIPTION
R3025		NRSA02J-0R0X	MG RESISTOR 0Ω,1/10W	R3209		NRSA02J-273X	MG RESISTOR 27kΩ,1/10W
R3026		NRSA02J-0R0X	MG RESISTOR 0Ω,1/10W	R3210		NRSA02J-181X	MG RESISTOR 180Ω,1/10W
R3027		NRSA02J-0R0X	MG RESISTOR 0Ω,1/10W	R3211		NRSA02J-273X	MG RESISTOR 27kΩ,1/10W
R3029		NRSA02J-472X	MG RESISTOR 4.7kΩ,1/10W	R3212		NRSA02J-474X	MG RESISTOR 470kΩ,1/10W
R3030		NRSA02J-472X	MG RESISTOR 4.7kΩ,1/10W	R3213		NRSA02J-334X	MG RESISTOR 330kΩ,1/10W
R3031		NRSA02J-0R0X	MG RESISTOR 0Ω,1/10W	R3214		NRSA02J-103X	MG RESISTOR 10kΩ,1/10W
R3032		NRSA02J-0R0X	MG RESISTOR 0Ω,1/10W	R3215		NRSA02J-103X	MG RESISTOR 10kΩ,1/10W
R3038		NRSA02J-152X	MG RESISTOR 1.5kΩ,1/10W	R3216		NRSA02J-103X	MG RESISTOR 10kΩ,1/10W
R3040		NRSA02J-0R0X	MG RESISTOR 0Ω,1/10W	R3217		NRSA02J-562X	MG RESISTOR 5.6kΩ,1/10W
R3041		NRSA02J-0R0X	MG RESISTOR 0Ω,1/10W	R3218		QRE141J-472Y	RESISTOR 4.7kΩ,1/4W
R3042		NRSA02J-0R0X	MG RESISTOR 0Ω,1/10W	R3219		NRSA02J-472X	MG RESISTOR 4.7kΩ,1/10W
R3044		QRE141J-0R0Y	RESISTOR 0Ω,1/4W	R3220		NRSA02J-104X	MG RESISTOR 100kΩ,1/10W
R3046		QRE141J-102Y	RESISTOR 1kΩ,1/4W	R3222		NRSA02J-472X	MG RESISTOR 4.7kΩ,1/10W
R3047		QRE141J-102Y	RESISTOR 1kΩ,1/4W	R3223		NRSA02J-472X	MG RESISTOR 4.7kΩ,1/10W
R3048		QRE141J-102Y	RESISTOR 1kΩ,1/4W	R3224		NRSA02J-472X	MG RESISTOR 4.7kΩ,1/10W
R3049		NRSA02J-0R0X	MG RESISTOR 0Ω,1/10W	R3225		NRSA02J-103X	MG RESISTOR 10kΩ,1/10W
R3050		NRSA02J-0R0X	MG RESISTOR 0Ω,1/10W	R3229		NRSA02J-105X	MG RESISTOR 1MΩ,1/10W
R3051		NRSA02J-471X	MG RESISTOR 470Ω,1/10W	R3230		NRSA02J-472X	MG RESISTOR 4.7kΩ,1/10W
R3052		NRSA02J-471X	MG RESISTOR 470Ω,1/10W	R3231		NRSA02J-102X	MG RESISTOR 1kΩ,1/10W
R3053		NRSA02J-471X	MG RESISTOR 470Ω,1/10W	R3233		NRSA02J-103X	MG RESISTOR 10kΩ,1/10W
R3054		NRSA02J-0R0X	MG RESISTOR 0Ω,1/10W	R3234		NRSA02J-103X	MG RESISTOR 10kΩ,1/10W
R3055		NRSA02J-0R0X	MG RESISTOR 0Ω,1/10W	R3235		NRSA02J-102X	MG RESISTOR 1kΩ,1/10W
R3056		NRSA02J-102X	MG RESISTOR 1kΩ,1/10W	R3236		NRSA02J-102X	MG RESISTOR 1kΩ,1/10W
R3057		NRSA02J-102X	MG RESISTOR 1kΩ,1/10W	R3237		NRSA02J-103X	MG RESISTOR 10kΩ,1/10W
R3058		NRSA02J-102X	MG RESISTOR 1kΩ,1/10W	R3238		QRE141J-103Y	RESISTOR 10kΩ,1/4W
R3059		NRSA02J-0R0X	MG RESISTOR 0Ω,1/10W	R3239		NRSA02J-103X	MG RESISTOR 10kΩ,1/10W
R3060		NRSA02J-471X	MG RESISTOR 470Ω,1/10W	R3241		NRSA02J-104X	MG RESISTOR 100kΩ,1/10W
R3061		NRSA02J-471X	MG RESISTOR 470Ω,1/10W	R3242		NRSA02J-472X	MG RESISTOR 4.7kΩ,1/10W
R3062		NRSA02J-103X	MG RESISTOR 10kΩ,1/10W	R3244		NRSA02J-103X	MG RESISTOR 10kΩ,1/10W
R3063		NRSA02J-0R0X	MG RESISTOR 0Ω,1/10W	R3247		NRSA02J-0R0X	MG RESISTOR 0Ω,1/10W
R3066		NRSA02J-472X	MG RESISTOR 4.7kΩ,1/10W	R3251		NRSA02J-103X	MG RESISTOR 10kΩ,1/10W
R3069		NRSA02J-101X	MG RESISTOR 100Ω,1/10W	R3501		NRSA02J-153X	MG RESISTOR 15kΩ,1/10W
R3071		NRSA02J-103X	MG RESISTOR 10kΩ,1/10W	R3502		NRSA02J-272X	MG RESISTOR 2.7kΩ,1/10W
R3072		NRSA02J-0R0X	MG RESISTOR 0Ω,1/10W	R3503		NRSA02J-153X	MG RESISTOR 15kΩ,1/10W
R3073		NRSA02J-0R0X	MG RESISTOR 0Ω,1/10W	R3504		NRSA02J-223X	MG RESISTOR 22kΩ,1/10W
R3075		NRSA02J-471X	MG RESISTOR 470Ω,1/10W	R3505		NRSA02J-562X	MG RESISTOR 5.6kΩ,1/10W
R3076		NRSA02J-471X	MG RESISTOR 470Ω,1/10W	R3506		NRSA02J-123X	MG RESISTOR 12kΩ,1/10W
R3078		NRSA02J-0R0X	MG RESISTOR 0Ω,1/10W	R3671		NRSA02J-103X	MG RESISTOR 10kΩ,1/10W
R3083		NRSA02J-0R0X	MG RESISTOR 0Ω,1/10W	R3672		NRSA02J-103X	MG RESISTOR 10kΩ,1/10W
R3085		NRSA02J-0R0X	MG RESISTOR 0Ω,1/10W	R3673		NRSA02J-103X	MG RESISTOR 10kΩ,1/10W
R3086		NRSA02J-0R0X	MG RESISTOR 0Ω,1/10W	R4001		NRSA02J-472X	MG RESISTOR 4.7kΩ,1/10W
R3087		NRSA02J-0R0X	MG RESISTOR 0Ω,1/10W	R4003		NRSA02J-561X	MG RESISTOR 560Ω,1/10W
R3088		NRSA02J-0R0X	MG RESISTOR 0Ω,1/10W	R4004		NRSA02J-561X	MG RESISTOR 560Ω,1/10W
R3089		NRSA02J-0R0X	MG RESISTOR 0Ω,1/10W	R4005		NRSA02J-562X	MG RESISTOR 5.6kΩ,1/10W
R3090		NRSA02J-0R0X	MG RESISTOR 0Ω,1/10W	R4007		NRSA02J-102X	MG RESISTOR 1kΩ,1/10W
R3091		NRSA02J-102X	MG RESISTOR 1kΩ,1/10W	R4008		NRSA02J-102X	MG RESISTOR 1kΩ,1/10W
R3094		QRE141J-0R0Y	RESISTOR 0Ω,1/4W	R4009		NRSA02J-102X	MG RESISTOR 1kΩ,1/10W
R3095		QRE141J-0R0Y	RESISTOR 0Ω,1/4W	R4010		NRSA02J-103X	MG RESISTOR 10kΩ,1/10W
R3096		QRE141J-0R0Y	RESISTOR 0Ω,1/4W	R4011		NRSA02J-102X	MG RESISTOR 1kΩ,1/10W
R3097		NRSA02J-0R0X	MG RESISTOR 0Ω,1/10W	R4012		NRSA02J-222X	MG RESISTOR 2.2kΩ,1/10W
R3103		NRSA02J-0R0X	MG RESISTOR 0Ω,1/10W	R4013		NRSA02J-102X	MG RESISTOR 1kΩ,1/10W
R3105		NRSA02J-102X	MG RESISTOR 1kΩ,1/10W	R4014		NRSA02J-182X	MG RESISTOR 1.8kΩ,1/10W
R3106		NRSA02J-102X	MG RESISTOR 1kΩ,1/10W	R4015		NRSA02J-223X	MG RESISTOR 22kΩ,1/10W
R3201		NRSA02J-103X	MG RESISTOR 10kΩ,1/10W	R4016		NRSA02J-103X	MG RESISTOR 10kΩ,1/10W
R3202		NRSA02J-472X	MG RESISTOR 4.7kΩ,1/10W	R4017		NRSA02J-102X	MG RESISTOR 1kΩ,1/10W
R3203		NRSA02J-103X	MG RESISTOR 10kΩ,1/10W	R4018		NRSA02J-102X	MG RESISTOR 1kΩ,1/10W
R3204		NRSA02J-222X	MG RESISTOR 2.2kΩ,1/10W	R4019		NRSA02J-103X	MG RESISTOR 10kΩ,1/10W
R3205		QRE141J-181Y	RESISTOR 180Ω,1/4W	R4020		NRSA02J-103X	MG RESISTOR 10kΩ,1/10W
R3206		QRE141J-183Y	RESISTOR 18kΩ,1/4W	R4021		NRSA02J-103X	MG RESISTOR 10kΩ,1/10W
R3207		NRSA02J-183X	MG RESISTOR 18kΩ,1/10W	△ R5001		QRZ9046-475Z	RESISTOR 4.7MΩ,1/2W
R3208		NRSA02J-181X	MG RESISTOR 180Ω,1/10W	R5101		QRG02GJ-104	OMF RESISTOR 100kΩ,2W

#	△	REF No.	PART No.	PART NAME, DESCRIPTION	#	△	REF No.	PART No.	PART NAME, DESCRIPTION
		R5102	QRE141J-820Y	RESISTOR 82Ω,1/4W			C4	NCF21CZ-105X	CAPACITOR 1μF,16V
		R5103	NRSA02J-681X	MG RESISTOR 680Ω,1/10W			C5	QEK0JM-476	E CAPACITOR 47μF,6.3V
		R5104	QRG02GJ-683	OMF RESISTOR 68kΩ,2W			C6	NCB11EK-104X	CAPACITOR 0.1μF,25V
		R5105	QRT01DJ-R39X	MF RESISTOR 0.39Ω,1W			C7	NCB21HK-102X	CAPACITOR 0.001μF,50V
		R5106	NRSA02J-562X	MG RESISTOR 5.6kΩ,1/10W			C8	NCB21EK-104X	CAPACITOR 0.1μF,25V
		R5301	QRE141J-1R0Y	RESISTOR 1Ω,1/4W			C9	QETN1HM-225	E CAPACITOR 2.2μF,50V
		R5302	NRSA02J-102X	MG RESISTOR 1kΩ,1/10W			C10	NDC21HG-151X	CAPACITOR 150pF,50V
		R5303	NRSA02J-122X	MG RESISTOR 1.2kΩ,1/10W			C11	NCB21EK-104X	CAPACITOR 0.1μF,25V
	△	R5304	QRZ9005-221X	FUSI RESISTOR 220Ω,1/4W			C12	NDC21HJ-120X	CAPACITOR 12pF,50V
		R5305	NRSA02J-471X	MG RESISTOR 470Ω,1/10W			C14	NCB21EK-104X	CAPACITOR 0.1μF,25V
		R5306	NRSA02J-683X	MG RESISTOR 68kΩ,1/10W			C15	NCB21HK-103X	CAPACITOR 0.01μF,50V
		R5308	NRSA02J-472X	MG RESISTOR 4.7kΩ,1/10W			C16	NCB11EK-104X	CAPACITOR 0.1μF,25V
		R5309	QRE141J-222Y	RESISTOR 2.2kΩ,1/4W			C17	QEKJ1HM-335	E CAPACITOR 3.3μF,50V
		R5327	NRVA02D-303X	CMF RESISTOR 30kΩ,1/10W			C19	QEKJ1CM-106	E CAPACITOR 10μF,16V
		R5330	NRSA02J-103X	MG RESISTOR 10kΩ,1/10W			C20	QEKJ1HM-105	E CAPACITOR 1μF,50V
		R5332	NRSA02J-103X	MG RESISTOR 10kΩ,1/10W			C21	NCB21EK-104X	CAPACITOR 0.1μF,25V
		R5334	QRE141J-103Y	RESISTOR 10kΩ,1/4W			C22	QEKJ0JM-476	E CAPACITOR 47μF,6.3V
		R5335	NRSA02J-472X	MG RESISTOR 4.7kΩ,1/10W			C23	NCB21EK-104X	CAPACITOR 0.1μF,25V
		R5336	NRSA02J-222X	MG RESISTOR 2.2kΩ,1/10W			C24	NCB21EK-104X	CAPACITOR 0.1μF,25V
		R6020	NRSA02J-102X	MG RESISTOR 1kΩ,1/10W			C25	NDC21HJ-4R0X	CAPACITOR 4pF,50V
		R6021	NRSA02J-102X	MG RESISTOR 1kΩ,1/10W			C26	NCB21HK-103X	CAPACITOR 0.01μF,50V
		R6022	NRSA02J-102X	MG RESISTOR 1kΩ,1/10W			C27	NCB21HK-223X	CAPACITOR 0.022μF,50V
		R6031	NRSA02J-0R0X	MG RESISTOR 0Ω,1/10W			C28	QEKJ1HM-335	E CAPACITOR 3.3μF,50V
		R6032	NRSA02J-123X	MG RESISTOR 12kΩ,1/10W			C29	NCB21HK-472X	CAPACITOR 0.0047μF,50V
		R6050	NRSA02J-0R0X	MG RESISTOR 0Ω,1/10W			C30	NCB21CK-474X	CAPACITOR 0.47μF,16V
		R6053	NRSA02J-102X	MG RESISTOR 1kΩ,1/10W			C31	QEKJ0JM-476	E CAPACITOR 47μF,6.3V
		R6061	NRSA02J-103X	MG RESISTOR 10kΩ,1/10W			C32	QCFB1HZ-104	CAPACITOR 0.1μF,50V
		R6508	NRSA02J-0R0X	MG RESISTOR 0Ω,1/10W			C33	QEKJ1HM-225	E CAPACITOR 2.2μF,50V
		R6510	NRSA02J-0R0X	MG RESISTOR 0Ω,1/10W			C34	NCB21EK-104X	CAPACITOR 0.1μF,25V
		R6551	QRE141J-271Y	RESISTOR 270Ω,1/4W			C35	NCB21EK-104X	CAPACITOR 0.1μF,25V
		R6552	NRSA02J-101X	MG RESISTOR 100Ω,1/10W			C36	QEKJ1EM-475	E CAPACITOR 4.7μF,25V
		R6553	QRE141J-0R0Y	RESISTOR 0Ω,1/4W			C37	NCB21AK-105X	CAPACITOR 1μF,10V
		R6554	QRE141J-0R0Y	RESISTOR 0Ω,1/4W			C38	QEKJ0JM-476	E CAPACITOR 47μF,6.3V
		R7202	NRSA02J-221X	MG RESISTOR 220Ω,1/10W			C39	NCB21EK-104X	CAPACITOR 0.1μF,25V
		R7203	NRSA02J-472X	MG RESISTOR 4.7kΩ,1/10W			C40	QEKJ1CM-106	E CAPACITOR 10μF,16V
		R7204	QRE121J-100Y	RESISTOR 10Ω,1/2W			C54	NDC21HJ-221X	CAPACITOR 220pF,50V
		B3	NRSA02J-0R0X	MG RESISTOR 0Ω,1/10W			C59	NCB21EK-104X	CAPACITOR 0.1μF,25V
		B8	NRSA02J-0R0X	MG RESISTOR 0Ω,1/10W			C60	QEKJ0JM-476	E CAPACITOR 47μF,6.3V
		B18	NRSA02J-0R0X	MG RESISTOR 0Ω,1/10W			C61	NCB21HK-103X	CAPACITOR 0.01μF,50V
		B38	NRSA02J-0R0X	MG RESISTOR 0Ω,1/10W			C63	NCB21EK-104X	CAPACITOR 0.1μF,25V
		B42	NRSA02J-0R0X	MG RESISTOR 0Ω,1/10W			C64	NDC21HJ-120X	CAPACITOR 12pF,50V
		B49	NRSA02J-0R0X	MG RESISTOR 0Ω,1/10W			C71	NCB21HK-103X	CAPACITOR 0.01μF,50V
		B52	NRSA02J-0R0X	MG RESISTOR 0Ω,1/10W			C72	NDC21HJ-470X	CAPACITOR 47pF,50V
		B2101	NRSA02J-0R0X	MG RESISTOR 0Ω,1/10W			C73	NDC21HJ-120X	CAPACITOR 12pF,50V
		B2501	QUY160-175Y	IM BUS WIRE			C74	NDC21HJ-120X	CAPACITOR 12pF,50V
		B3001	NRSA02J-0R0X	MG RESISTOR 0Ω,1/10W			C80	NCB21HK-103X	CAPACITOR 0.01μF,50V
		B3002	NRSA02J-0R0X	MG RESISTOR 0Ω,1/10W			C84	NDC21HJ-220X	CAPACITOR 22pF,50V
		B3004	NRSA02J-0R0X	MG RESISTOR 0Ω,1/10W			C94	NRSA02J-0R0X	MG RESISTOR 0Ω,1/10W
		B3012	QUY160-200Y	IM BUS WIRE			C106	NDC21HJ-560X	CAPACITOR 56pF,50V
		B3030	NRSA02J-0R0X	MG RESISTOR 0Ω,1/10W			C108	NDC21HJ-150X	CAPACITOR 15pF,50V
		B5001	QUY160-100Y	IM BUS WIRE			C109	NCB21CK-224X	CAPACITOR 0.22μF,16V
		B5002	QUY160-100Y	IM BUS WIRE			C110	NCB21HK-331X	CAPACITOR 330pF,50V
		B5301	NRSA02J-0R0X	MG RESISTOR 0Ω,1/10W			C401	NCB21EK-103X	CAPACITOR 0.01μF,25V
		B5303	NRSA02J-0R0X	MG RESISTOR 0Ω,1/10W			C402	NCB21HK-223X	CAPACITOR 0.022μF,50V
		B5304	NRSA02J-0R0X	MG RESISTOR 0Ω,1/10W			C403	NDC21HJ-151X	CAPACITOR 150pF,50V
		B5306	NRSA02J-0R0X	MG RESISTOR 0Ω,1/10W			C404	NDC21HJ-470X	CAPACITOR 47pF,50V
		B7252	NRSA02J-0R0X	MG RESISTOR 0Ω,1/10W			C406	NDC21HJ-681X	CAPACITOR 680pF,50V
		B7255	QUY160-125Y	IM BUS WIRE			C407	NDC21HJ-180X	CAPACITOR 18pF,50V
		C1	NCF21CZ-105X	CAPACITOR 1μF,16V			C2001	QETN1HM-475	E CAPACITOR 4.7μF,50V
		C2	NCF21CZ-105X	CAPACITOR 1μF,16V			C2002	QEKJ1CM-106	E CAPACITOR 10μF,16V
		C3	NCF21CZ-105X	CAPACITOR 1μF,16V			C2003	QEKJ0JM-476	E CAPACITOR 47μF,6.3V

#	△ REF No.	PART No.	PART NAME, DESCRIPTION	#	△ REF No.	PART No.	PART NAME, DESCRIPTION	
C2004		NCB21HK-103X	CAPACITOR	0.01μF,50V	C2518	NCB21HK-102X	CAPACITOR	0.001μF,50V
C2005		QEKJ1EM-475	E CAPACITOR	4.7μF,25V	C2519	NCB21HK-103X	CAPACITOR	0.01μF,50V
C2006		NCB21HK-123X	CAPACITOR	0.012μF,50V	C2520	NCB21HK-103X	CAPACITOR	0.01μF,50V
C2007		QEKJ1CM-226	E CAPACITOR	22μF,16V	C3001	NCB21EK-104X	CAPACITOR	0.1μF,25V
C2008		QERF1EM-475	E CAPACITOR	4.7μF,25V	C3002	NCB21HK-103X	CAPACITOR	0.01μF,50V
C2009		NCB21HK-102X	CAPACITOR	0.001μF,50V	C3003	QEKJ1CM-106	E CAPACITOR	10μF,16V
C2010		NCB21HK-222X	CAPACITOR	0.0022μF,50V	C3004	NCB21EK-104X	CAPACITOR	0.1μF,25V
C2011		QEKJ1EM-475	E CAPACITOR	4.7μF,25V	C3008	NCB21HK-103X	CAPACITOR	0.01μF,50V
C2012		QEKJ1EM-475	E CAPACITOR	4.7μF,25V	C3011	QETL0JM-478	E CAPACITOR	4700μF,6.3V
C2051		NCB21HK-331X	CAPACITOR	330pF,50V	C3012	QEKJ0JM-107	E CAPACITOR	100μF,6.3V
C2061		QFLC1HJ-333Z	F CAPACITOR	0.033μF,50V	C3015	NCB21EK-104X	CAPACITOR	0.1μF,25V
C2062		NCB21HK-332X	CAPACITOR	0.0033μF,50V	C3016	NCF21CZ-105X	CAPACITOR	1μF,16V
C2063		NCB21HK-103X	CAPACITOR	0.01μF,50V	C3022	NCB21EK-104X	CAPACITOR	0.1μF,25V
C2064		QEKJ1CM-106	E CAPACITOR	10μF,16V	C3024	NDC21HJ-120X	CAPACITOR	12pF,50V
C2101		QEKJ1CM-106	E CAPACITOR	10μF,16V	C3026	NCB21HK-103X	CAPACITOR	0.01μF,50V
C2102		QEKJ1CM-106	E CAPACITOR	10μF,16V	C3027	NBE20JM-106X	T CAPACITOR	10μF,6.3V
C2104		NCB21EK-104X	CAPACITOR	0.1μF,25V	C3030	NBE20JM-226X	T CAPACITOR	22μF,6.3V
C2202		NCB21EK-333X	CAPACITOR	0.033μF,25V	C3031	NCB21HK-102X	CAPACITOR	0.001μF,50V
C2203		QEKJ1CM-106	E CAPACITOR	10μF,16V	C3032	NCB21EK-104X	CAPACITOR	0.1μF,25V
C2204		QDGB1HK-102Y	CAPACITOR	0.001μF,50V	C3033	NCB21EK-104X	CAPACITOR	0.1μF,25V
C2205		QEKJ1HM-105	E CAPACITOR	1μF,50V	C3036	NDC21HJ-180X	CAPACITOR	18pF,50V
C2206		QEKJ1CM-106	E CAPACITOR	10μF,16V	C3037	NDC21HJ-120X	CAPACITOR	12pF,50V
C2207		QEKJ1CM-476	E CAPACITOR	47μF,16V	C3040	QCFB1HZ-104	CAPACITOR	0.1μF,50V
C2208		QETN1HM-475	E CAPACITOR	4.7μF,50V	C3041	NDC21HJ-100X	CAPACITOR	10pF,50V
C2209		QERF1HM-104	E CAPACITOR	0.1μF,50V	C3042	QEKJ0JM-107	E CAPACITOR	100μF,6.3V
C2210		QEKJ1HM-104	E CAPACITOR	0.1μF,50V	C3501	NCB21EK-104X	CAPACITOR	0.1μF,25V
C2211		QERF1HM-105	E CAPACITOR	1μF,50V	C3502	QEKJ1CM-106	E CAPACITOR	10μF,16V
C2212		QEKJ1HM-105	E CAPACITOR	1μF,50V	C3503	NCB21HK-103X	CAPACITOR	0.01μF,50V
C2215		QERF1EM-475	E CAPACITOR	4.7μF,25V	C3602	NCB21EK-104X	CAPACITOR	0.1μF,25V
C2216		QEKJ1HM-474	E CAPACITOR	0.47μF,50V	C3652	NCB21EK-104X	CAPACITOR	0.1μF,25V
C2217		QEKJ1CM-106	E CAPACITOR	10μF,16V	C4002	NCB21EK-104X	CAPACITOR	0.1μF,25V
C2218		QEKJ1HM-474	E CAPACITOR	0.47μF,50V	C4003	NCB21HK-102X	CAPACITOR	0.001μF,50V
C2219		QEKJ1CM-106	E CAPACITOR	10μF,16V	C4004	NBE20JM-226X	T CAPACITOR	22μF,6.3V
C2220		QEKJ1EM-475	E CAPACITOR	4.7μF,25V	C4006	NBE40JM-476X	T CAPACITOR	47μF,6.3V
C2221		NCB21HK-103X	CAPACITOR	0.01μF,50V	C4007	NCB21HK-102X	CAPACITOR	0.001μF,50V
C2222		QEKJ1HM-474	E CAPACITOR	0.47μF,50V	C4008	NCB21AK-105X	CAPACITOR	1μF,10V
C2223		QEKJ1HM-474	E CAPACITOR	0.47μF,50V	C4009	NCB21HK-563X	CAPACITOR	0.056μF,50V
C2224		NCB21HK-103X	CAPACITOR	0.01μF,50V	C4010	NCB21EK-223X	CAPACITOR	0.022μF,25V
C2225		QEKJ1EM-475	E CAPACITOR	4.7μF,25V	C4011	NCB21EK-104X	CAPACITOR	0.1μF,25V
C2226		QEKJ1CM-106	E CAPACITOR	10μF,16V	C4012	NCB21EK-224X	CAPACITOR	0.22μF,25V
C2227		NCB21CK-104X	CAPACITOR	0.1μF,16V	C4013	NCB21HK-563X	CAPACITOR	0.056μF,50V
C2229		NDC21HJ-101X	CAPACITOR	100pF,50V	C4014	NDC21HJ-101X	CAPACITOR	100pF,50V
C2230		NDC21HJ-101X	CAPACITOR	100pF,50V	C4015	NCB21HK-102X	CAPACITOR	0.001μF,50V
C2231		NCB21HK-102X	CAPACITOR	0.001μF,50V	C4017	NCB21HK-222X	CAPACITOR	0.0022μF,50V
C2251		QEKJ1CM-476	E CAPACITOR	47μF,16V	△ C5001	QFZ9073-683	F CAPACITOR	0.068μF,250V
C2252		NCB21HK-103X	CAPACITOR	0.01μF,50V	△ C5004	QCZ9094-472	CAPACITOR	0.0047μF,250V
C2253		NCB21CK-104X	CAPACITOR	0.1μF,16V	C5006	QETM2DM-157	E CAPACITOR	150μF,200V
C2254		NCB21CK-104X	CAPACITOR	0.1μF,16V	C5101	QCZ0212-472	CAPACITOR	0.0047μF,1kV
C2256		QEKJ0JM-107	E CAPACITOR	100μF,6.3V	C5102	QEMU1VM-276	E CAPACITOR	27μF,35V
C2501		QERF0JM-107	E CAPACITOR	100μF,6.3V	C5103	QCZ0136-101Z	CAPACITOR	100pF,1kV
C2502		NCB21HK-562X	CAPACITOR	0.0056μF,50V	C5104	QFLC1HJ-471Z	F CAPACITOR	470pF,50V
C2503		QERF1HM-105	E CAPACITOR	1μF,50V	C5107	QCZ0136-101Z	CAPACITOR	100pF,1kV
C2505		QEKJ0JM-107	E CAPACITOR	100μF,6.3V	C5201	QEMU0JM-227	E CAPACITOR	220μF,6.3V
C2506		NCB21HK-103X	CAPACITOR	0.01μF,50V	C5202	QEMT1CM-827	E CAPACITOR	820μF,16V
C2507		QERF1CM-226	E CAPACITOR	22μF,16V	C5203	QEMT1AM-158	E CAPACITOR	1500μF,10V
C2508		NCB21HK-103X	CAPACITOR	0.01μF,50V	C5204	QETN2AM-475	E CAPACITOR	4.7μF,100V
C2509		QERF1CM-106	E CAPACITOR	10μF,16V	C5205	QETN1HM-106	E CAPACITOR	10μF,50V
C2510		QEKJ1CM-476	E CAPACITOR	47μF,16V	C5206	QEMU1EM-187	E CAPACITOR	180μF,25V
C2511		NCB21HK-222X	CAPACITOR	0.0022μF,50V	C5207	QETN1CM-227	E CAPACITOR	220μF,16V
C2512		NDC21HJ-331X	CAPACITOR	330pF,50V	C5208	QETN1AM-227	E CAPACITOR	220μF,10V
C2513		NCB21HK-103X	CAPACITOR	0.01μF,50V	C5212	QEMU1VM-127	E CAPACITOR	120μF,35V

#	△	REF No.	PART No.	PART NAME, DESCRIPTION	
C5213			QEMU0JM-227	E CAPACITOR	220µF,6.3V
C5301			QETM0JM-108	E CAPACITOR	1000µF,6.3V
C5302			QETN1HM-106	E CAPACITOR	10µF,50V
C5303			QETN1CM-107	E CAPACITOR	100µF,16V
C5304			QFVF1HJ-274Z	F CAPACITOR	0.27µF,50V
C5305			NCB21HK-103X	CAPACITOR	0.01µF,50V
C6054			NDC21HJ-220X	CAPACITOR	22pF,50V
C6055			NDC21HJ-220X	CAPACITOR	22pF,50V
C7202			QETJ0JM-477	E CAPACITOR	470µF,6.3V
L1			QQL29BJ-100Z	COIL	10µH
L2			QQL231J-680Y	COIL	68µH
L3			QQL29BJ-100Z	COIL	10µH
L4			QQL29BJ-100Z	COIL	10µH
L5			QQL29BJ-100Z	COIL	10µH
L11			QQL01BJ-120Z	COIL	12µH
L13			QQL231J-101Y	COIL	100µH
L15			QQL29BJ-100Z	COIL	10µH
L18			QUY153-050Y	IM BUS WIRE	
L19			QQL231J-100Y	COIL	10µH
L20			QUY153-050Y	IM BUS WIRE	
L24			QQL231J-180Y	COIL	18µH
L27			QQL231J-151Y	COIL	150µH
L28			QQL231J-150Y	COIL	15µH
L401			QQL071J-150Y	COIL	15µH
L402			QUY153-050Y	IM BUS WIRE	
L2001			QUY153-050Y	IM BUS WIRE	
L2251			QQL29BJ-100Z	COIL	10µH
L2501			QQL29BJ-2R2Z	COIL	2.2µH
L3001			QUY153-050Y	IM BUS WIRE	
L3501			QUY153-050Y	IM BUS WIRE	
L5201			PELN1184	COIL	33µH
L5202			PU60944-330K	COIL	33µH
L6001			QUY153-050Y	IM BUS WIRE	
L6003			QUY153-050Y	IM BUS WIRE	
L6005			QUY153-050Y	IM BUS WIRE	
L6031			NRSA02J-0R0X	MG RESISTOR	0Ω,1/10W
L6032			QUY153-050Y	IM BUS WIRE	
L6050			QQL29BK-1R0Z	COIL	1µH
L7201			QQL01BJ-101Z	COIL	100µH
LPF2501			PELN1137	LOW PASS FILTER	
CF2501			QAX0399-001Z	RESONATOR	
LC2501			QQL29BJ-100Z	COIL	10µH
X2			QAX0575-001	CRYSTAL RESONATOR	
X3001			QAX0444-001	CRYSTAL RESONATOR	
X3002			QAX0527-001	CRYSTAL RESONATOR	
S3002			QSW0695-001	PUSH SWITCH,S CASS SW	
K2251			NQR0007-001X	FERRITE BEAD	
K2252			NQR0007-001X	FERRITE BEAD	
K2253			NQR0007-001X	FERRITE BEAD	
K5101			QQR0678-001Z	FERRITE BEAD	
K5102			QQR0678-001Z	FERRITE BEAD	
PC3001			GP3S123	IC(PHOTO SENSOR)	
PC3002			GP3S123	IC(PHOTO SENSOR)	
△	PC5101		PC817	IC(PHOTO COUPLER)	
	T2052		PELN0861	OSC TRANSFORMER	
△	T5001		QQS0057-001	SW TRANSFORMER	
	TU6001		QAU0163-001	TUNER	
	ET1		PQ21623-1-5	EARTH PLATE(RF)	
	ET2		LP40658-001B	EARTH PLATE(1)	
	HS1		LP40621-001A	HEAT SINK,IC5101	
	SD1		LP30720-001A	SHIELD CASE(PRE/REC)	

#	△	REF No.	PART No.	PART NAME, DESCRIPTION	
WR11			QUB371-14ZAZA	SIN TWIST WIRE	
FC5001			QNG0006-001Z	FUSE CLIP,F5001	
FC5002			QNG0006-001Z	FUSE CLIP,F5001	
OT1			QYTD5F3010Z	SCREW,X2 TERMINAL	
OT2			PU59915-107	#500SPACER0.01,WR11	
OT3			QYTDST3008Z	SCREW,IC5101	
△	LF5002		QQR0532-001	LINE FILTER	
△	SG5001		QAF0046-242Z	SURGE ABSORBER	
△	VA5001		QAF0039-431Z	VARISTOR	
△	VA5002		QAF0039-431Z	VARISTOR	
CN1			QGF1028C1-13	FPC CONNECTOR,(4-16)U.DRUM	
CN901			QGF1207C1-04	FPC CONNECTOR,(1-4)FRONT S IN	
CN902			QGF1207C1-05	FPC CONNECTOR,(1-5)FRONT IN	
CN903			QGB2024K1-12S	CONNECTOR,(1-12)TERMINAL	
CN904			QGB2024K1-12S	CONNECTOR,(1-12)TERMINAL	
CN905			QGB2024K1-05S	CONNECTOR,(1-5)TERMINAL	
CN907			QGB2024K1-10S	CONNECTOR,(1-10)TERMINAL	
CN1901			QGF1207C1-11	FPC CONNECTOR,(1-11)GR	
CN2001			QGF1207C1-07	FPC CONNECTOR,(1-7)A/C HEAD	
CN2002			QGB2532J1-02	CONNECTOR,(1-2)FE HEAD	
CN2051			QGB2024K1-04S	CONNECTOR,(1-4)AUDIO ERASE	
CN3001			QGF1207C1-05	FPC CONNECTOR,(1-5)DRUM MDA	
CN3002			QGB2532J1-02	CONNECTOR,(1-2)LOADING MOTOR	
CN3003			QGB2015M2-08	CONNECTOR,(1-8)CAPSTAN MOTOR	
CN3004			QGB2534J2-04	CONNECTOR,(1-4)ROTARY ENCODER	
CN3011			QGF1207C1-14	FPC CONNECTOR,(1-14)FRONT	
CN3012			QGF1207C1-06	FPC CONNECTOR,(1-6)JOG	
CN3501			QGB2011L2-06	CONNECTOR,(1-6)DD MDA	
△	CN5001		QGA7901C3-02	CONNECTOR,(1-2)AC IN	
△	CP4001		ICP-N25	CIRCUIT PROTECTOR	
△	CP5301		ICP-N38	CIRCUIT PROTECTOR	
△	CP5302		ICP-N25	CIRCUIT PROTECTOR	
△	F5001		QMF51N2-1R25J1	FUSE	T1.25A,AC250V

3D DIGITAL/4M BOARD ASSEMBLY <05>					
PW1			LPA10143-02A	3D DIGITAL/4M BOARD ASSY	
IC1401			JCP8026	IC	
IC1402			MN47V77S-XE	IC	
Q1401			2SC1317/RS-T	TRANSISTOR	
Q1402			2SA1576A/QR/-X	TRANSISTOR	
			or 2PA1576/R/-X	TRANSISTOR	
Q1403			2SA1576A/QR/-X	TRANSISTOR	
			or 2PA1576/R/-X	TRANSISTOR	
Q1406			2SA1576A/QR/-X	TRANSISTOR	
			or 2PA1576/R/-X	TRANSISTOR	
Q1407			2SA1576A/QR/-X	TRANSISTOR	
			or 2PA1576/R/-X	TRANSISTOR	
Q1408			2SC4081/S/-X	TRANSISTOR	
Q1410			2SC4081/QRS/-X	TRANSISTOR	
			or 2PC4081/R/-X	TRANSISTOR	
Q1412			2SC4081/QRS/-X	TRANSISTOR	
			or 2PC4081/R/-X	TRANSISTOR	
Q1413			2SA1576A/QR/-X	TRANSISTOR	
			or 2PA1576/R/-X	TRANSISTOR	

#	△ REF No.	PART No.	PART NAME, DESCRIPTION	#	△ REF No.	PART No.	PART NAME, DESCRIPTION
Q1417		2SA1576A/QR/-X or 2PA1576R/-X	TRANSISTOR	C1410		QEKJ1EM-475	E CAPACITOR 4.7μF,25V
Q1418		2SA1576A/QR/-X or 2PA1576R/-X	TRANSISTOR	C1411		NCF21EZ-104X	CAPACITOR 0.1μF,25V
Q1419		DTC124TU	DIGI TRANSISTOR	C1412		NDC21HJ-680X	CAPACITOR 68pF,50V
D1401		RD4.3ES/B2/-T2 or MTZJ4.3B	ZENER DIODE	C1413		NDC21HJ-330X	CAPACITOR 33pF,50V
D1402		1SS133 or 1N4148M	DIODE	C1415		NCF21EZ-104X	CAPACITOR 0.1μF,25V
R1401		NRSA02J-271X	MG RESISTOR 270Ω,1/10W	C1416		QEKJ1CM-106	E CAPACITOR 10μF,16V
R1402		NRSA02J-101X	MG RESISTOR 100Ω,1/10W	C1417		NCF21EZ-104X	CAPACITOR 0.1μF,25V
R1404		NRSA02J-182X	MG RESISTOR 1.8kΩ,1/10W	C1421		NDC21HJ-330X	CAPACITOR 33pF,50V
R1406		NRSA02J-471X	MG RESISTOR 470Ω,1/10W	C1422		NDC21HJ-680X	CAPACITOR 68pF,50V
R1407		NRSA02J-272X	MG RESISTOR 2.7kΩ,1/10W	C1423		NCF21EZ-104X	CAPACITOR 0.1μF,25V
R1410		NRSA02J-241X	MG RESISTOR 240Ω,1/10W	C1424		NCB21HK-103X	CAPACITOR 0.01μF,50V
R1411		NRSA02J-152X	MG RESISTOR 1.5kΩ,1/10W	C1425		NCB21HK-103X	CAPACITOR 0.01μF,50V
R1413		NRSA02J-471X	MG RESISTOR 470Ω,1/10W	C1426		NDC21HJ-390X	CAPACITOR 39pF,50V
R1414		NRSA02J-821X	MG RESISTOR 820Ω,1/10W	C1428		NDC21HJ-220X	CAPACITOR 22pF,50V
R1415		NRSA02J-221X	MG RESISTOR 220Ω,1/10W	C1429		QEKJ0JM-337	E CAPACITOR 330μF,6.3V
R1416		NRSA02J-104X	MG RESISTOR 100kΩ,1/10W	C1430		NCF21EZ-104X	CAPACITOR 0.1μF,25V
R1417		NRSA02J-101X	MG RESISTOR 100Ω,1/10W	C1432		NCF21CZ-105X	CAPACITOR 1μF,16V
R1418		NRSA02J-471X	MG RESISTOR 470Ω,1/10W	C1433		NCF21EZ-104X	CAPACITOR 0.1μF,25V
R1421		NRSA02J-331X	MG RESISTOR 330Ω,1/10W	C1435		NCF21EZ-104X	CAPACITOR 0.1μF,25V
R1426		NRSA02J-821X	MG RESISTOR 820Ω,1/10W	C1436		NCF21EZ-104X	CAPACITOR 0.1μF,25V
R1427		NRSA02J-333X	MG RESISTOR 33kΩ,1/10W	C1437		NCF21EZ-104X	CAPACITOR 0.1μF,25V
R1428		NRSA02J-393X	MG RESISTOR 39kΩ,1/10W	C1438		NCF21EZ-104X	CAPACITOR 0.1μF,25V
R1429		NRSA02J-152X	MG RESISTOR 1.5kΩ,1/10W	C1439		NCF21CZ-105X	CAPACITOR 1μF,16V
R1430		NRSA02J-222X	MG RESISTOR 2.2kΩ,1/10W	C1440		NCF21EZ-104X	CAPACITOR 0.1μF,25V
R1431		NRSA02J-821X	MG RESISTOR 820Ω,1/10W	C1441		NCF21EZ-104X	CAPACITOR 0.1μF,25V
R1432		NRSA02J-182X	MG RESISTOR 1.8kΩ,1/10W	C1442		NCF21CZ-105X	CAPACITOR 1μF,16V
R1433		NRSA02J-510X	MG RESISTOR 51Ω,1/10W	C1444		NCF21EZ-104X	CAPACITOR 0.1μF,25V
R1434		NRSA02J-153X	MG RESISTOR 15kΩ,1/10W	C1445		NCF21EZ-104X	CAPACITOR 0.1μF,25V
R1435		NRSA02J-103X	MG RESISTOR 10kΩ,1/10W	C1446		QEKJ0JM-107	E CAPACITOR 100μF,6.3V
R1436		NRSA02J-392X	MG RESISTOR 3.9kΩ,1/10W	C1447		NCF21EZ-104X	CAPACITOR 0.1μF,25V
R1437		NRSA02J-392X	MG RESISTOR 3.9kΩ,1/10W	C1448		QEKJ0JM-337	E CAPACITOR 330μF,6.3V
R1438		NRSA02J-473X	MG RESISTOR 47kΩ,1/10W	C1449		NCF21EZ-104X	CAPACITOR 0.1μF,25V
R1439		NRSA02J-273X	MG RESISTOR 27kΩ,1/10W	C1451		QEKJ1EM-475	E CAPACITOR 4.7μF,25V
R1440		NRSA02J-473X	MG RESISTOR 47kΩ,1/10W	C1452		NCF21EZ-104X	CAPACITOR 0.1μF,25V
R1446		NRSA02J-102X	MG RESISTOR 1kΩ,1/10W	C1453		NCF21EZ-104X	CAPACITOR 0.1μF,25V
R1447		NRSA02J-102X	MG RESISTOR 1kΩ,1/10W	C1454		NCF21EZ-104X	CAPACITOR 0.1μF,25V
R1448		NRSA02J-102X	MG RESISTOR 1kΩ,1/10W	C1455		NCF21EZ-104X	CAPACITOR 0.1μF,25V
R1449		NRSA02J-102X	MG RESISTOR 1kΩ,1/10W	C1456		QEKJ0JM-337	E CAPACITOR 330μF,6.3V
R1450		NRSA02J-102X	MG RESISTOR 1kΩ,1/10W	C1457		NCF21EZ-104X	CAPACITOR 0.1μF,25V
R1452		NRSA02J-102X	MG RESISTOR 1kΩ,1/10W	C1458		NCF21EZ-104X	CAPACITOR 0.1μF,25V
R1453		NRSA02J-102X	MG RESISTOR 1kΩ,1/10W	C1459		NDC21HJ-470X	CAPACITOR 47pF,50V
R1455		NRSA02J-681X	MG RESISTOR 680Ω,1/10W	C1460		NDC21HJ-470X	CAPACITOR 47pF,50V
R1458		NRSA02J-561X	MG RESISTOR 560Ω,1/10W	C1462		NDC21HJ-470X	CAPACITOR 47pF,50V
R1459		NRSA02J-681X	MG RESISTOR 680Ω,1/10W	C1463		QEKJ0JM-336	E CAPACITOR 33μF,6.3V
R1460		NRSA02J-273X	MG RESISTOR 27kΩ,1/10W	C1465		NDC21HJ-470X	CAPACITOR 47pF,50V
R1462		NRSA02J-0R0X	MG RESISTOR 0Ω,1/10W	C1466		NDC21HJ-470X	CAPACITOR 47pF,50V
VR1401		QVZ3521-103Z	V RESISTOR,D/A LEVEL	C1467		NDC21HJ-470X	CAPACITOR 47pF,50V
B1417		NRSA02J-0R0X	MG RESISTOR 0Ω,1/10W	C1468		NDC21HJ-470X	CAPACITOR 47pF,50V
B1419		NRSA02J-0R0X	MG RESISTOR 0Ω,1/10W	C1471		NCF21EZ-104X	CAPACITOR 0.1μF,25V
C1401		QEKJ1CM-336	E CAPACITOR 33μF,16V	C1472		NCF21EZ-104X	CAPACITOR 0.1μF,25V
C1402		NCB21HK-103X	CAPACITOR 0.01μF,50V	C1473		NCF21EZ-104X	CAPACITOR 0.1μF,25V
C1403		QEKJ0JM-337	E CAPACITOR 330μF,6.3V	L1401		QQL29BJ-100Z	COIL 10μH
C1404		NCF21EZ-104X	CAPACITOR 0.1μF,25V	L1402		QQL071J-6R8Y	COIL 6.8μH
C1405		NCF21EZ-104X	CAPACITOR 0.1μF,25V	L1403		QQL071J-6R8Y	COIL 6.8μH
C1406		NCB21HK-103X	CAPACITOR 0.01μF,50V	L1404		QQL071J-6R8Y	COIL 6.8μH
C1407		NDC21HJ-680X	CAPACITOR 68pF,50V	L1405		QQL29BJ-100Z	COIL 10μH
C1408		NDC21HJ-330X	CAPACITOR 33pF,50V	L1406		QQL071J-330Y	COIL 33μH
				L1407		QQL29BJ-100Z	COIL 10μH
				L1408		QQL29BJ-4R7Z	COIL 4.7μH
				LC1401		QQR0521-013Z	NOISE FILTER

#	△	REF No.	PART No.	PART NAME, DESCRIPTION	#	△	REF No.	PART No.	PART NAME, DESCRIPTION
		LC1402	QQR0521-010Z	NOISE FILTER			R3468	NRSA02J-103X	MG RESISTOR 10kΩ,1/10W
		SD1	LP30706-001C	SHIELD FRAME(S-VHS)			B3301	NRSA02J-0R0X	MG RESISTOR 0Ω,1/10W
		SD2	LP30684-001A	SHIELD CASE(S-VHS)			B3401	NRSA02J-0R0X	MG RESISTOR 0Ω,1/10W
		CN1401	QGG2502K1-17	HEADER PIN			B3402	NRSA02J-0R0X	MG RESISTOR 0Ω,1/10W
							B3405	NRSA02J-0R0X	MG RESISTOR 0Ω,1/10W
							B3406	NRSA02J-0R0X	MG RESISTOR 0Ω,1/10W
							B3407	NRSA02J-0R0X	MG RESISTOR 0Ω,1/10W
							B3408	NRSA02J-0R0X	MG RESISTOR 0Ω,1/10W
							B3409	NRSA02J-0R0X	MG RESISTOR 0Ω,1/10W
							B3410	NRSA02J-0R0X	MG RESISTOR 0Ω,1/10W
							B3411	NRSA02J-0R0X	MG RESISTOR 0Ω,1/10W
							C3312	NDC21HJ-200X	CAPACITOR 20pF,50V
							C3313	NDC21HJ-200X	CAPACITOR 20pF,50V
							C3314	NCB21EK-104X	CAPACITOR 0.1μF,25V
							C3321	NDC21HJ-220X	CAPACITOR 22pF,50V
							C3322	NDC21HJ-220X	CAPACITOR 22pF,50V
							C3323	NDC21HJ-220X	CAPACITOR 22pF,50V
							C3333	NCB21EK-104X	CAPACITOR 0.1μF,25V
							C3345	NDC21HJ-220X	CAPACITOR 22pF,50V
							C3346	NDC21HJ-220X	CAPACITOR 22pF,50V
							C3347	NDC21HJ-220X	CAPACITOR 22pF,50V
							C3401	QEKJ0JM-226	E CAPACITOR 22μF,6.3V
							C3402	NCB21EK-104X	CAPACITOR 0.1μF,25V
							C3403	NCB21EK-104X	CAPACITOR 0.1μF,25V
							C3404	NCB21EK-104X	CAPACITOR 0.1μF,25V
							C3405	NCB21EK-104X	CAPACITOR 0.1μF,25V
							X3301	QAX0584-001	CRYSTAL RESONATOR
							BK1	LP40425-001A	BRACKET(BOARD)
							CN3401	QGG2502K1-13	HEADER PIN
							CN3402	QGF1207F1-08	FPC CONNECTOR,(1-8)

NAVIGATION BOARD ASSEMBLY <19>

PW1	LPA10145-02A	NAVIGATION BOARD ASSY	
IC3301	MN101C12GCC	IC (MCU)	
	or MN101CP12GAFFC	IC (MCU)	
IC3401	74HC4053D	IC	
IC3402	74HC4053D	IC	
IC3403	AT45D011-SC-X	IC	
D3401	RB751V-40-X	SB DIODE	
D3407	1SS355	DIODE	
R3302	NRSA02J-0R0X	MG RESISTOR	0Ω,1/10W
R3313	NRSA02J-101X	MG RESISTOR	100Ω,1/10W
R3321	NRSA02J-0R0X	MG RESISTOR	0Ω,1/10W
R3322	NRSA02J-0R0X	MG RESISTOR	0Ω,1/10W
R3323	NRSA02J-0R0X	MG RESISTOR	0Ω,1/10W
R3326	NRSA02J-102X	MG RESISTOR	1kΩ,1/10W
R3328	NRSA02J-0R0X	MG RESISTOR	0Ω,1/10W
R3329	NRSA02J-0R0X	MG RESISTOR	0Ω,1/10W
R3330	NRSA02J-0R0X	MG RESISTOR	0Ω,1/10W
R3331	NRSA02J-223X	MG RESISTOR	22kΩ,1/10W
R3332	NRSA02J-223X	MG RESISTOR	22kΩ,1/10W
R3333	NRSA02J-102X	MG RESISTOR	1kΩ,1/10W
R3339	NRSA02J-102X	MG RESISTOR	1kΩ,1/10W
R3340	NRSA02J-102X	MG RESISTOR	1kΩ,1/10W
R3342	NRSA02J-0R0X	MG RESISTOR	0Ω,1/10W
R3343	NRSA02J-0R0X	MG RESISTOR	0Ω,1/10W
R3345	NRSA02J-0R0X	MG RESISTOR	0Ω,1/10W
R3346	NRSA02J-0R0X	MG RESISTOR	0Ω,1/10W
R3347	NRSA02J-0R0X	MG RESISTOR	0Ω,1/10W
R3348	NRSA02J-0R0X	MG RESISTOR	0Ω,1/10W
R3349	NRSA02J-0R0X	MG RESISTOR	0Ω,1/10W
R3350	NRSA02J-0R0X	MG RESISTOR	0Ω,1/10W
R3351	NRSA02J-0R0X	MG RESISTOR	0Ω,1/10W
R3352	NRSA02J-0R0X	MG RESISTOR	0Ω,1/10W
R3371	NRSA02J-0R0X	MG RESISTOR	0Ω,1/10W
R3372	NRSA02J-0R0X	MG RESISTOR	0Ω,1/10W
R3373	NRSA02J-0R0X	MG RESISTOR	0Ω,1/10W
R3386	NRSA02J-103X	MG RESISTOR	10kΩ,1/10W
R3401	NRSA02J-0R0X	MG RESISTOR	0Ω,1/10W
R3402	NRSA02J-0R0X	MG RESISTOR	0Ω,1/10W
R3403	NRSA02J-0R0X	MG RESISTOR	0Ω,1/10W
R3404	NRSA02J-0R0X	MG RESISTOR	0Ω,1/10W
R3412	NRSA02J-0R0X	MG RESISTOR	0Ω,1/10W
R3414	NRSA02J-0R0X	MG RESISTOR	0Ω,1/10W
R3415	NRSA02J-0R0X	MG RESISTOR	0Ω,1/10W
R3422	NRSA02J-0R0X	MG RESISTOR	0Ω,1/10W
R3432	NRSA02J-0R0X	MG RESISTOR	0Ω,1/10W
R3462	NRSA02J-103X	MG RESISTOR	10kΩ,1/10W
R3465	NRSA02J-472X	MG RESISTOR	4.7kΩ,1/10W
R3466	NRSA02J-0R0X	MG RESISTOR	0Ω,1/10W